

# Factory Interior Finishes

## Ultra Coat and Ultra Stain



It's tough to beat a factory finish applied with state-of-the-art equipment under rigorously controlled, ultra-clean conditions. There are two options to choose from, Ultra Coat and Ultra Stain\*. All visible interior surfaces will be finished including exterior wood surfaces on our casement and awning products that are viewed when the sash is in the open position.



\*The Ultra Stain interior finish is currently not available on all product lines. Contact your Sierra Pacific Windows representative for details.

### Factory Interior Finish Options

Ten interior color options of water-based, nearly zero VOC paint, as well as Clear, Espresso, and Toffee color stain options.

Ultra Coat		Ultra Stain
White	Accessible Beige	Clear
Black	Urbane Bronze	Espresso
Dried Thyme	Iron Ore	Toffee
Creamy	Deep Forest Brown	
Requisite Gray	Anchors Aweigh	

### The Finishing Process

Sierra Pacific preps and finishes each wood component prior to window assembly, removing the additional steps of having to prep, sand, and finish an already assembled unit. So, once we have assembled your interior finished unit, it's ready to ship!

For both the Ultra Coat and Ultra Stain finishes, each component goes through a multi-step process of sanding, prepping, coating, and sealing.

While not always necessary, touch up of the finish should be expected on the jobsite.

## Coverage Area

The below illustrations will highlight the wood surfaces finished when Ultra Coat or Ultra Stain is selected.

Vertical Section Details

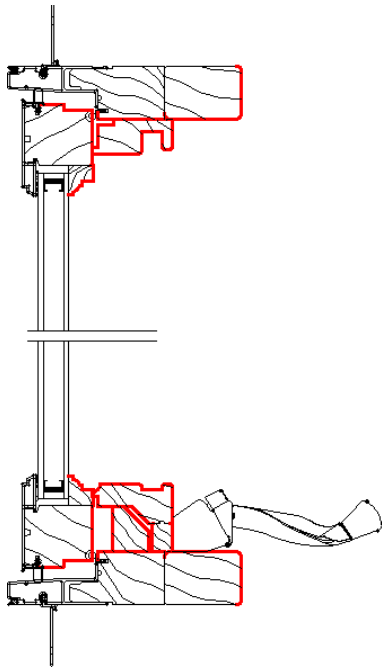

Horizontal Section Details

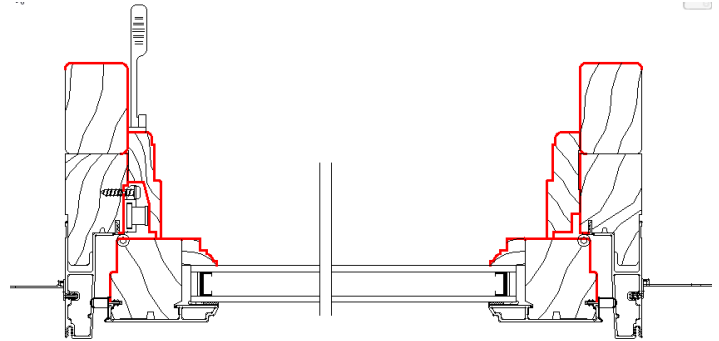

## Primed and Ready

Planning on painting the interior of the unit on site? Choose our primed interior option, which like our Ultra finish process, we prep and apply a water based prime coat to the interior wood components before assembly.

**Using a dark based paint color?** Choose our black prime coat option to limit the number of coats needed for finishing.

### Primed Interior Options

White

Black

## Custom Color Match

Sierra Pacific Windows is proud to align with Sherwin Williams® to offer custom color solutions for interior paint colors and interior wood stain finishes, as well as our exterior clad colors.

Our custom color offering is simple. Head to your Sherwin Williams store. Select a color you love. Then, just let us know the color name and code you selected. Remember, it is best to get a small sample pot to test it out yourself.

**Note:** When selecting interior stains, select from Sherwin Williams' 48 Minwax Wood Finish colors, but make sure to test your choice on pine (our default wood) as stain appearance varies by species. Stains are typically shown in stores on other wood species and results will differ.

*Ultra Coat and Ultra Stain finishes are a meticulous and advanced process to ensure maximum beauty of your wood window and door interiors. Yet, wood is a natural material with character, color, and grain patterns with varying densities, even in lumber taken from the same tree. Colors and stain absorption will vary based on the wood's natural character; therefore results are not guaranteed by Sierra Pacific Windows for color or grain consistency. While not always necessary, touch up in the field of the finish should be expected.*

Please contact your nearest Sierra Pacific Branch or Dealer location to see samples of our factory interior finish options on your choice of wood species. [www.sierrapacificwindows.com/WhereToBuy](http://www.sierrapacificwindows.com/WhereToBuy)